

Tom Yates

From: Mark Vonesch
Sent: October 31, 2023 3:28 PM
To: Gerald Whalley; Tom Yates
Cc: David Leitch; Edith Watson
Subject: gas tax funding for Cortes Housing Society road
Attachments: Cortes Gas tax for Cortes Housing Society Road Infrastructure.pdf

Hi Gerald and Tom, (Dave & Edith CC'ed)

I have attached a PDF description and quote for the building of preliminary road infrastructure for the Cortes Housing Society's Rainbow Ridge affordable rental housing development. Can this be added to the November 8th EASC agenda?

I will be making the following motion in connection to the quote:

Where as supporting affordable housing development is a priority for the Strathcona Regional District;

I move that \$140,000 be allocated from the Electoral Ara B Gas Tax Reserve Fund to assist the Cortes Housing Society in building road infrastructure for their affordable housing development.

Thanks!

Mark

Mark Vonesch
Regional Director - Cortes Island
Strathcona Regional District
250-202-4422

Cortes Island Gas Tax Fund for Road Infrastructure

The Rainbow Ridge affordable housing project on Cortes Island requires site infrastructure to support the construction of 24 rental townhomes. A \$140,000 contribution from Cortes Island's Gas Tax Fund would provide 100% of the budget towards creating road access, meeting Ministry of Transportation & Infrastructure (MOTI) subdivision requirements so that this housing project is more shovel-ready for BC Housing funding selection. The road building quote below is based upon the following assumptions:

- Access road is approx 120 meters Long as per attached map.
- Mass excavation depth 525mm Deep.
- 225mm Deep gravel base layer included.
- 300mm Deep gravel subbase layer included.
- Chip seal is excluded.
- Forming of the drainage ditch adjacent the road is included.
- Costs include imported material for all gravels.
- Contaminated soil/rock removal is excluded.
- Hydro is excluded.

Budget Road & Drainage Ditch	\$120,000
Contractor Project Management	<u>\$20,000</u>
TOTAL PROJECT COST	\$140,000

See attached map for further details.

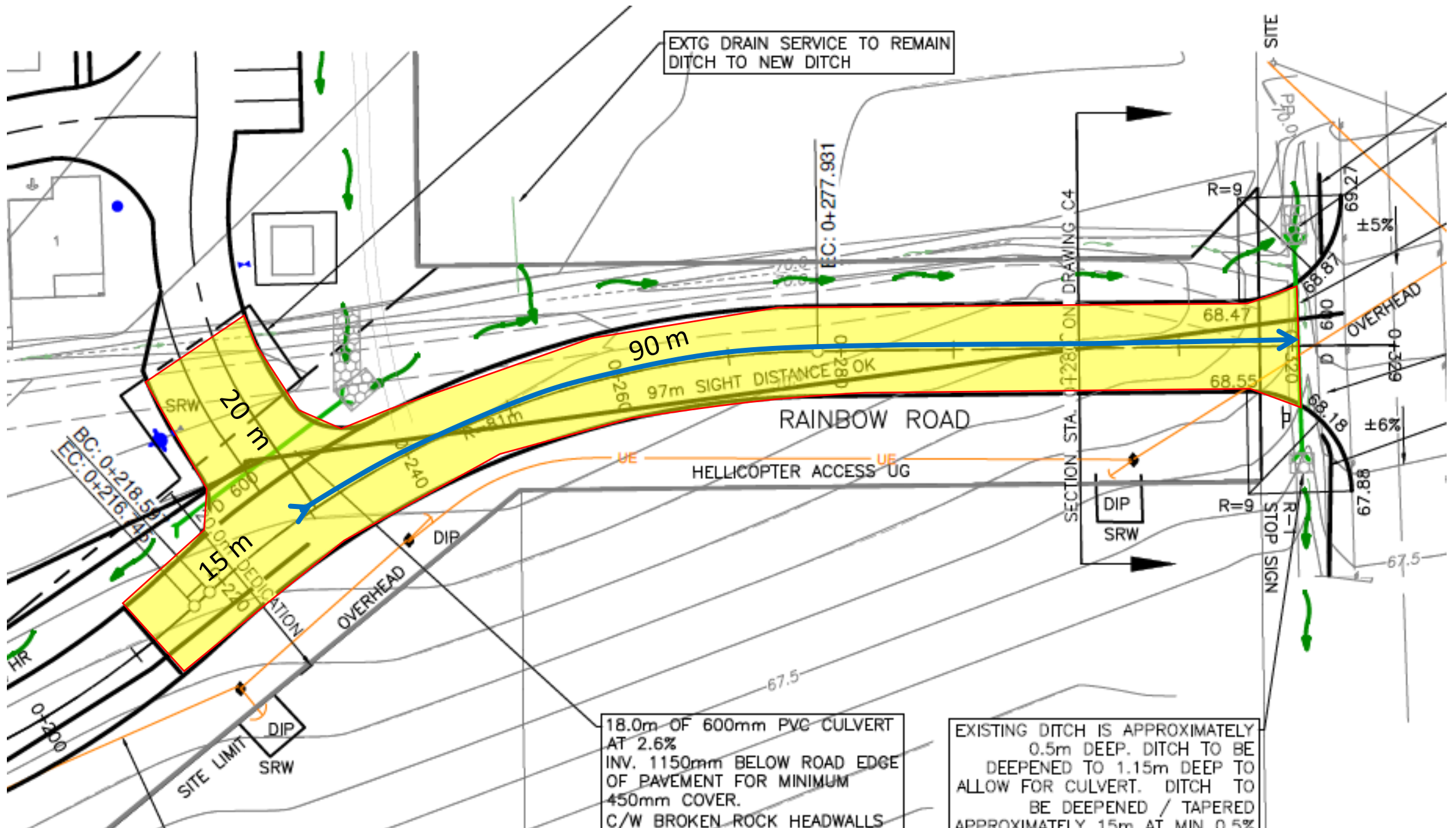

EXTG DRAIN SERVICE TO REMAIN
DITCH TO NEW DITCH

EC: 0+277.931

90 m

97m SIGHT DISTANCE OK

RAINBOW ROAD

HELICOPTER ACCESS UG

SECTION STA. 1+280 ON DRAWING C4

DIP
SRW

STOP SIGN

15 m

20 m

18.0m OF 600mm PVC CULVERT
AT 2.6%
INV. 1150mm BELOW ROAD EDGE
OF PAVEMENT FOR MINIMUM
450mm COVER.
C/W BROKEN ROCK HEADWALLS

EXISTING DITCH IS APPROXIMATELY
0.5m DEEP. DITCH TO BE
DEEPEMED TO 1.15m DEEP TO
ALLOW FOR CULVERT. DITCH TO
BE DEEPEMED / TAPERED
APPROXIMATELY 15m AT MIN 0.5%

BC: 0+218.5
EC: 0+216.4

SITE LIMIT
SRW

OVERHEAD

OVERHEAD

±5%

±6%

SITE

PRO

R=9

R=9

R=9

69.27

68.87

68.47

68.55

68.18

67.88

67.5

67.5

0+400

0+200

0+220

0+240

0+260

0+280

0+300

0+320

0+340

0+360

0+380

0+400

0+420

0+440

0+460

0+480

0+500

0+520

0+540

0+560

0+580

0+600

0+620

0+640

0+660

0+680

0+700

0+720

0+740

0+760

0+780

0+800